

SHEET NOTES:
 1. REFER TO SHEET PM000 FOR SYMBOLS ABBREVIATIONS AND GENERAL NOTES.

1 BASEMENT PLAN - FIRE PROTECTION | Q23
 SCALE: 1/8" = 1'-0"

1 1ST FLOOR PLAN - FIRE PROTECTION | Q8
 SCALE: 1/8" = 1'-0"

1 MEZZANINE PLAN - FIRE PROTECTION | B23
 SCALE: 1/8" = 1'-0"

1 2ND FLOOR PLAN - FIRE PROTECTION | B8
 SCALE: 1/8" = 1'-0"

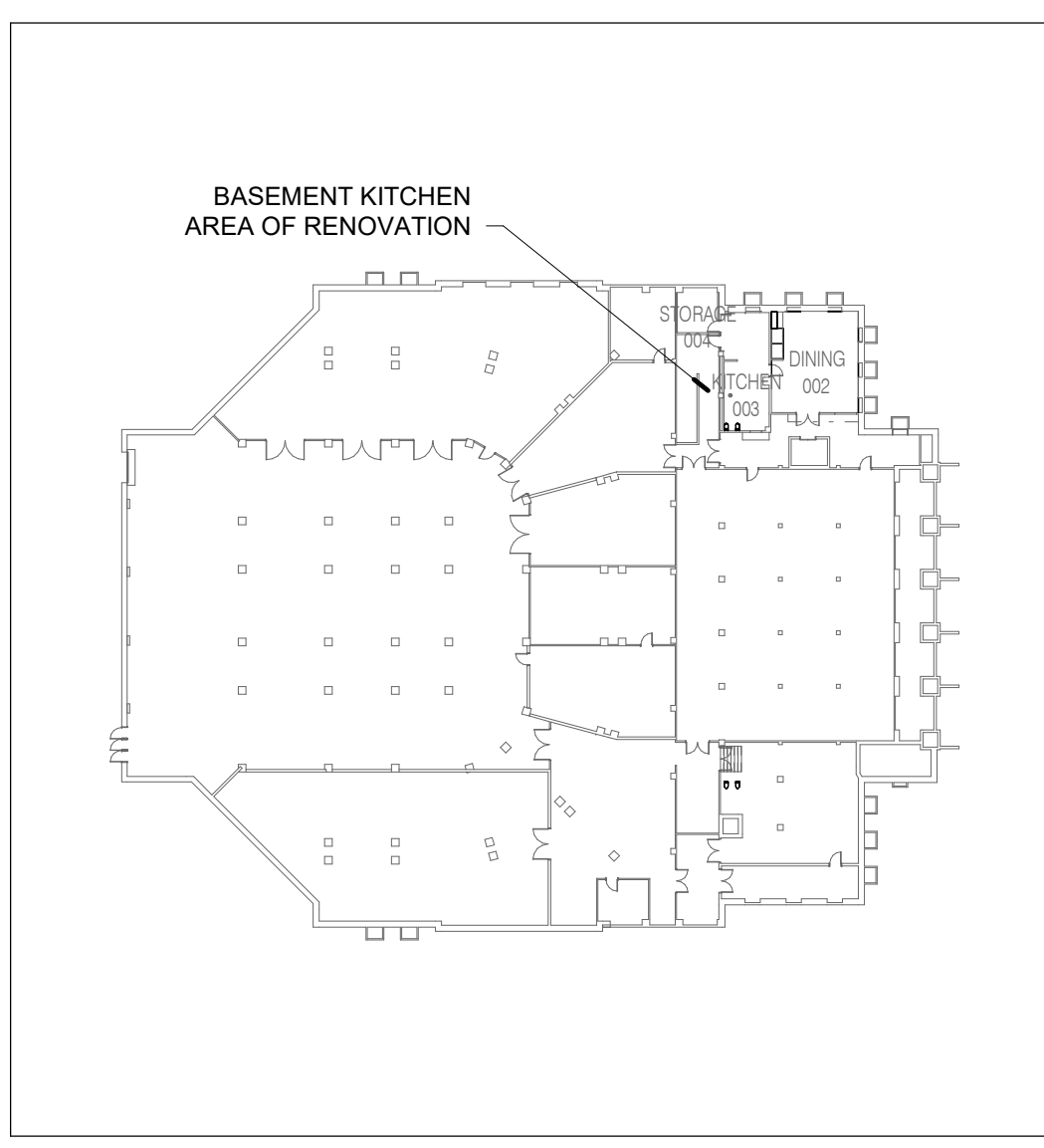

BASEMENT KEY PLAN | 5
 SCALE: 1" = 50'-0"

INTERNATIONAL ARCHITECTS ATELIER
 912 BROADWAY BLVD, SUITE 300 | KANSAS CITY, MO 64105
 P: 816.471.6522 | F: 816.471.3755 | W: IAA.COM
 MISSOURI STATE CERTIFICATE OF AUTHORITY #000582

MEP CONSULTANT
IMEG, CORP.
 1400 BALTIMORE AVE., SUITE 300
 KANSAS CITY, MO 64108
 PH: 816.842.8437

FOOD SERVICE DESIGN CONSULTANT
RICCA DESIGN STUDIOS
 5613 DTC PARKWAY, SUITE 100
 GREENWOOD VILLAGE, CO 80111
 PH: 303.221.0500

AUDIO/VISUAL DESIGN CONSULTANT
IMEG, CORP.
 8900 KEYSTONE CROSSING, SUITE 210
 INDIANAPOLIS, IN 46240
 PH: 317.848.5045

STRUCTURAL CONSULTANT
BOB D. CAMPBELL & CO.
 4338 BELLVIEW AVE.
 KANSAS CITY MO 64111
 PH: 816.531.4144



**UNIFIED
 GOVERNMENT
 MEMORIAL HALL
 KITCHEN &
 AUDIO/VISUAL
 RENOVATIONS
 ISSUED FOR BID**

600 N. 7TH ST TRFY
 KANSAS CITY, KANSAS 66101

DATE: 03/20/2025
 PROJ. NO.: B41456
 DESIGNED BY: CSB
 DRAWN BY: CSB
 CHECKED BY: SGB
 APPROVED BY: SGB

SEAL:

 3/27/2025
 STUART BRADEN - ENGINEER
 KS#: 11632

The Professional Engineer's seal affixed to this sheet applies only to the material and items shown on this sheet. All drawings, instruments, or other documents not exhibiting this seal shall not be considered prepared by this engineer, and this engineer expressly disclaims any and all responsibility for such plans, drawings, or documents not exhibiting this seal.

NO.	REVISION	SUBMISSION	DATE
0	ISSUED FOR BID		03/27/2025
1	ADDENDUM #1		04/11/2025

FIRE PROTECTION PLANS

F100

4/10/2025 2:28:58 PM